

# Transmission Assembly

## Removal

### ⚠ WARNING

- Make sure jacks and safety stands are placed properly, and hoist brackets are attached to correct positions on the engine.
- Apply parking brake and block rear wheels, so car will not roll off stands and fall on you while working under it.

**CAUTION:** Use fender covers to avoid damaging painted surfaces.

**NOTE:** The L and LS model radios have a coded theft protection circuit. If servicing to the car requires any of the following, be sure you get the customer's code number before you begin work:

- disconnecting the battery.
- removal of No. 56 fuse.
- removal of the radio.

After service, reconnect power to the radio and turn it on.

The word "CODE" will be displayed. Enter the customer's 5-digit code to restore radio operation.

1. Disconnect the battery negative (–) and positive (+) cables from the battery.
2. Remove the strut bar.
3. Drain the transmission oil.  
Reinstall the drain plug with a new washer.
4. Remove the control box.

**CAUTION:** Do not remove the vacuum tubes from the control box.

5. Disconnect the switch connectors.
6. Remove the transmission housing bolts.
7. Remove the clutch hose bracket from the rear engine hanger.

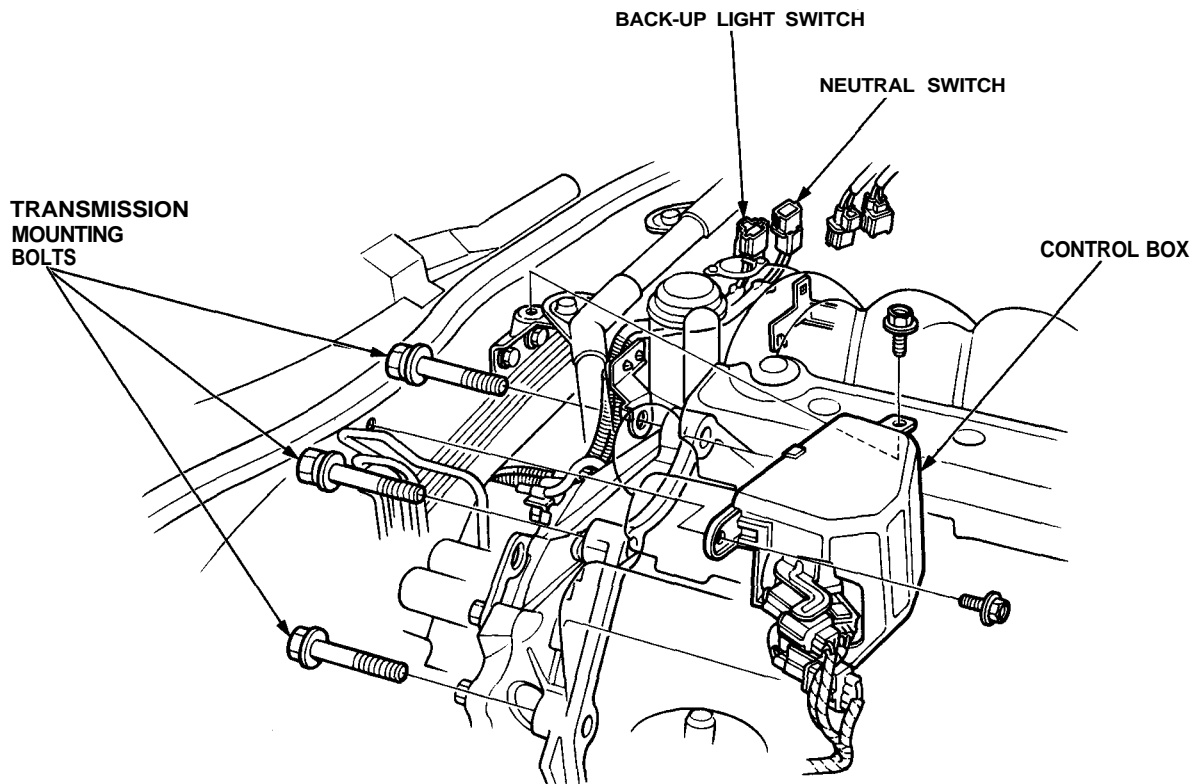



8. Remove the exhaust pipe B and A.
9. Remove the heat shield and bracket.

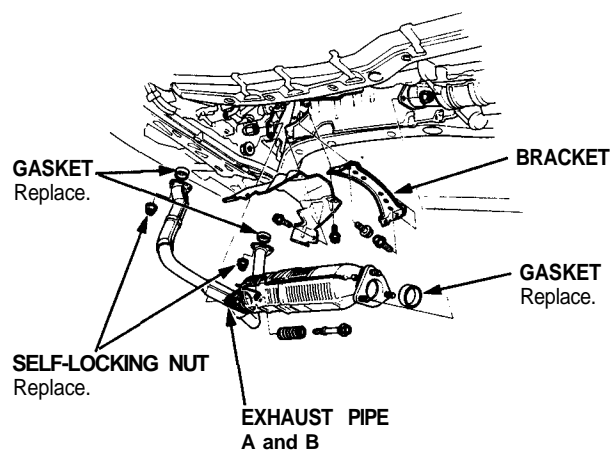

10. Remove the shift rod and torque rod.
11. Disconnect the cooler hoses from the oil pump pipes.

NOTE: Check for any signs of leakage at the oil pump pipes.

12. Remove the release fork cover and slave cylinder.

NOTE:

- Do not operate the clutch pedal once the slave cylinder has been removed.
- Take care not to bend the pipe.

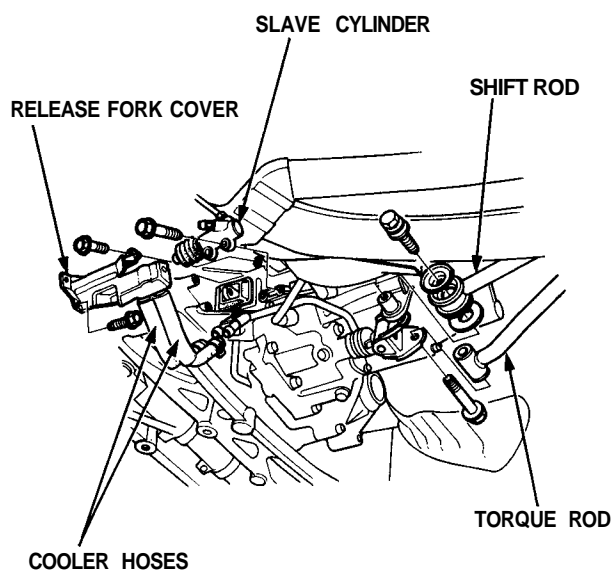

(cont'd)

# Transmission Assembly

## Removal (cont'd)

13. Remove the lower plate.

NOTE: Reinstall the steering gearbox mounting bolts.

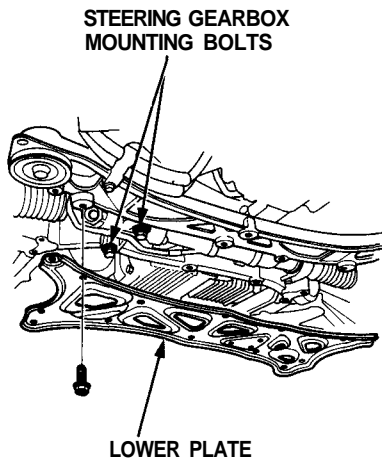

14. Remove the exhaust pipe stay.

15. Remove the transmission bracket and transmission mount.

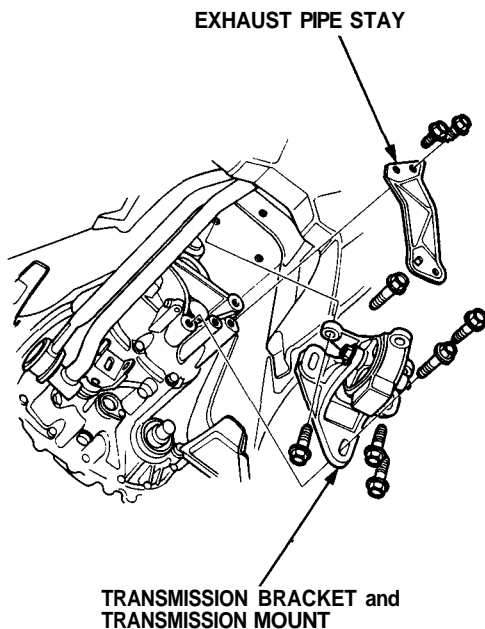

16. Remove the secondary cover and 36 mm sealing bolt.

NOTE: Shift the transmission to low gear to lock the secondary gear.

17. Disconnect the extension shaft from the differential using the special tool.

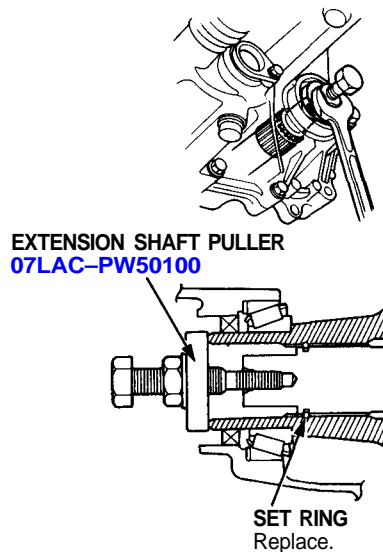

18. Place a jack under the transmission.

19. Remove the transmission mounts.

20. Remove the release fork from the clutch release hanger, then hang the release fork on the clutch housing.

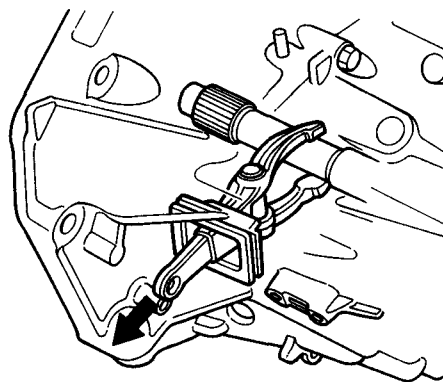



21. Remove the transmission housing mounting bolts.

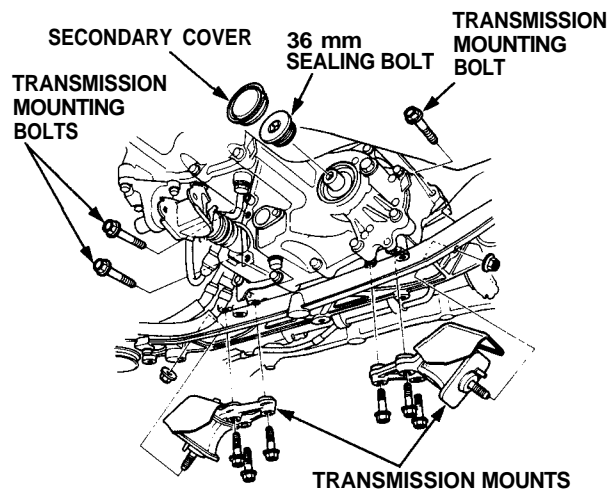

22. Remove the engine stiffener.

23. Remove the clutch housing cover.

24. Remove the transmission mounting bolts and 26 mm shim.

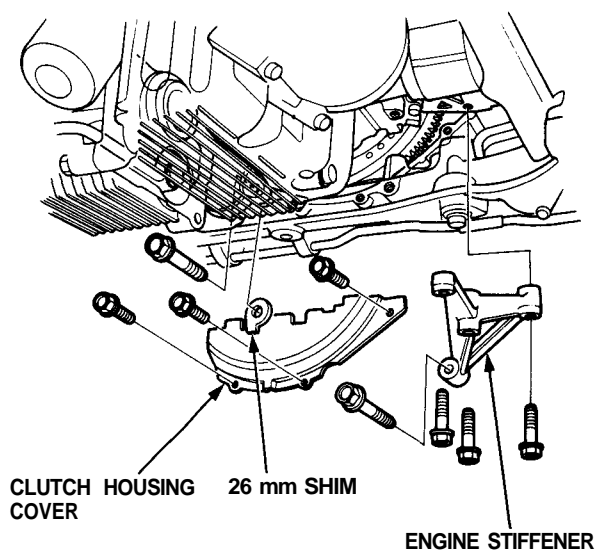

25. Pull the transmission away from the engine until it clears the mainshaft.